

VICINITY MAP

OFFICIAL PRELIMINARY PLAN
CUMBERLAND COUNTY

This plan approved by the Cumberland County Joint Planning Board Staff
on 1-23-08

Comments: Subject to Conditions

Case No.: CB-007

I certify that this plan has been approved by the Cumberland County Joint Planning Board Staff as drawn hereon and may be used for any official purpose as permitted by law. This approval is valid until 1-23-10

Patricia S. Speicher
Supervisor of Land Use Codes 638
Cumberland Co. Joint Planning Board

THIS DRAWING IS A
SCALED FOR CONST
PURPOSES, THE SCA
INDICATED IS FOR
REFERENCE OI

OFFICIAL PRELIMINARY PLAN
CUMBERLAND COUNTY

This plan approved by the Cumberland County Joint Planning Board Staff
on 5-11-10

Comments: Subject to Conditions

Case No.: DB-007

I certify that this plan has been approved by the Cumberland County Joint Planning Board Staff as drawn hereon and may be used for any official purpose as permitted by law. This approval is valid until 5-11-12

Patricia S. Speicher
Supervisor of Land Use Codes 638
Cumberland Co. Joint Planning Board

ADDITION TO
HONEYCUTT ELEMENTARY SCHOOL

Project #:
Drawn By:
Checked By:
Issue Date:
Revisions:

5-11-10
REVISION
ADDRESSING
CASE: 08-007

CASE: 08-007
OVERALL
STAFF COPY

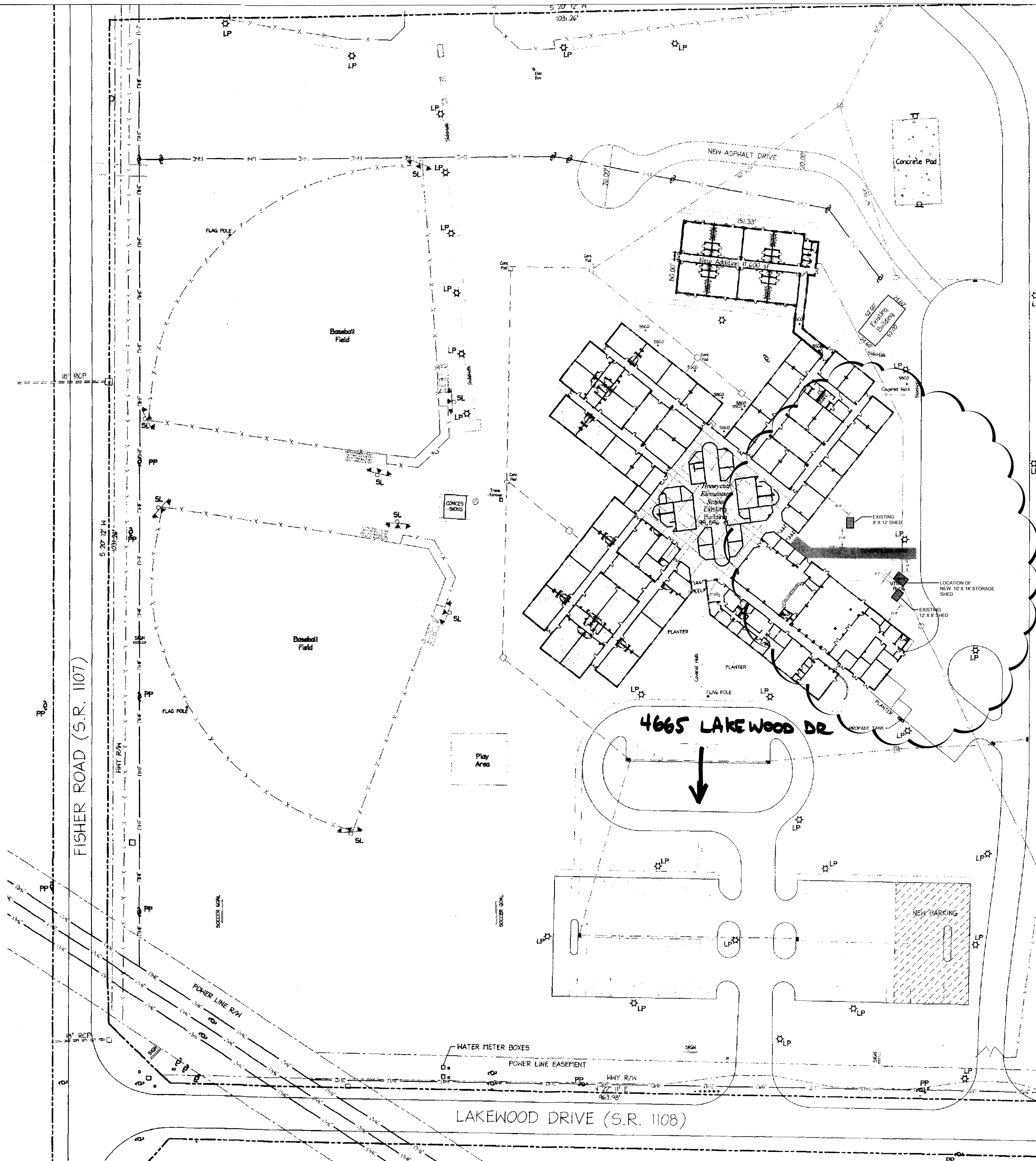

- LEGEND
- Property Boundary
 - - - Adjoining Property
 - - - Right of Way
 - Asphalt
 - - - - - Fenceline
 - Overhead Electric
 - EIS - Existing Iron Stake
 - EIP - Existing Iron Pipe
 - LP - Area Light
 - SL - Stadium Light
 - PP - Power Pole
 - Sanitary Sewer Clean Out
 - Drop Inlet
 - Sanitary Sewer Manhole
 - Storm Sewer Manhole
 - Curb Inlet

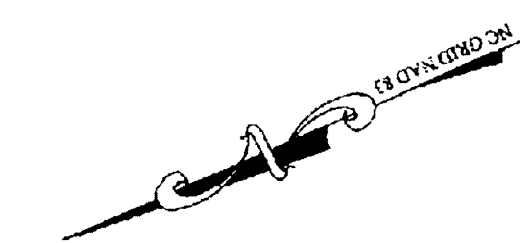

SITE PLAN 1
1" = 60'-0"

AC-1